

Nokia X2-02 User Guide

| | | | |
|--|-----------|--|-----------|
| Contents | | Write using traditional text input | 17 |
| Safety | 4 | Messaging | 17 |
| Your phone in brief | 5 | Send a message | 17 |
| Your dual SIM phone | 5 | Save an attachment | 18 |
| Keys and parts | 5 | Listen to voice messages | 19 |
| Get started | 7 | Send an audio message | 19 |
| Insert a SIM card and battery | 7 | Connectivity | 19 |
| Insert a second SIM card | 7 | Bluetooth | 19 |
| Insert a memory card | 8 | USB data cable | 22 |
| Charge the battery | 9 | Clock | 22 |
| Switch the phone on or off | 10 | Change the time and date | 22 |
| GSM antenna | 10 | Alarm clock | 22 |
| Connect a headset | 11 | Pictures and videos | 23 |
| Attach a strap | 11 | Take a picture | 23 |
| Basic use | 11 | Record a video | 23 |
| Support | 11 | Send a picture or video | 24 |
| Access codes | 12 | Organise files | 24 |
| Set which SIM card to use | 12 | Music and audio | 24 |
| Lock the keys | 13 | Media player | 24 |
| Copy contacts or pictures from your old phone | 13 | FM radio | 25 |
| Use your phone without a SIM card | 14 | Play via radio | 27 |
| Calls | 14 | Web | 28 |
| Make a call | 14 | About the web browser | 28 |
| View your missed calls | 14 | Browse the web | 28 |
| Call the last dialled number | 15 | Fit a web page to your phone display | 29 |
| Divert calls to your voice mailbox or another phone number | 15 | Add a bookmark | 29 |
| Contacts | 15 | Clear your browsing history | 30 |
| Save a name and phone number | 15 | Phone management | 30 |
| Use speed dial | 16 | Update phone software using your phone | 30 |
| Send your contact information | 16 | Update phone software using your PC | 31 |
| Write text | 16 | Restore original settings | 31 |
| Switch between text input modes | 16 | Back up your pictures and other content to a memory card | 31 |

Protect the environment 32

| | |
|-------------|----|
| Save energy | 32 |
|-------------|----|

| | |
|---------|----|
| Recycle | 32 |
|---------|----|

Product and safety information 32**Index 39**

Safety

Read these simple guidelines. Not following them may be dangerous or illegal. For further information, read the complete user guide.

SWITCH OFF IN RESTRICTED AREAS



Switch the device off when mobile phone use is not allowed or when it may cause interference or danger, for example, in aircraft, in hospitals or near medical equipment, fuel, chemicals, or blasting areas. Obey all instructions in restricted areas.

ROAD SAFETY COMES FIRST



Obey all local laws. Always keep your hands free to operate the vehicle while driving. Your first consideration while driving should be road safety.

INTERFERENCE



All wireless devices may be susceptible to interference, which could affect performance.

QUALIFIED SERVICE



Only qualified personnel may install or repair this product.

BATTERIES, CHARGERS, AND OTHER ACCESSORIES



Use only batteries, chargers, and other accessories approved by Nokia for use with this device. Do not connect incompatible products.

KEEP YOUR DEVICE DRY



Your device is not water-resistant. Keep it dry.

PROTECT YOUR HEARING



Listen to a headset at a moderate level, and do not hold the device near your ear when the loudspeaker is in use.

Your phone in brief

Your dual SIM phone

You can insert two SIM cards.

Some benefits of a dual SIM phone

- You can make savings when you use services from different service providers.
- Use one phone number for personal calls and another for work, but carry only one phone.
- Avoid network coverage variation between service providers.

Both SIM cards are available at the same time when the phone is not being used, but while one SIM card is active, for example, making a call, sending or receiving a message, or transferring data, the other is unavailable.

If there is no SIM card in the internal SIM card holder, you can only make emergency calls.

Some features and operator services are only available when using the SIM card in the internal SIM card holder.

A GPRS connection cannot be open in the background. If an application is using a GPRS connection, and you return to the home screen or switch to another application, menu, or other view, the connection is automatically closed.

Keys and parts

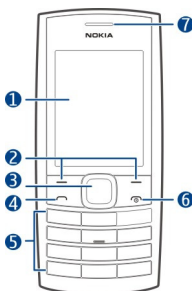

- 1 Display
- 2 Selection keys
- 3 Navi™ key (scroll key)
- 4 Call key

- 5 Keypad
- 6 End/Power key
- 7 Earpiece

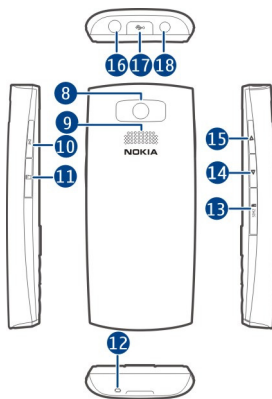

- 8 Camera lens
- 9 Loudspeaker
- 10 Media key
- 11 Memory card slot
- 12 Wrist strap hole
- 13 SIM card slot (SIM 2)
- 14 Volume down key
- 15 Volume up key
- 16 Headset connector/Nokia AV connector (3.5 mm)
- 17 Micro-USB connector
- 18 Charger connector

Media key functions

- To open the media player or radio, on the home screen, press and hold the media key. The last used application opens.
- If the media player or radio is already open in the background, press the media key.

Get started

Insert a SIM card and battery

This phone is intended for use with a BL-5C battery. Always use original Nokia batteries.

If you only have one SIM card, insert the card into the internal SIM card holder.

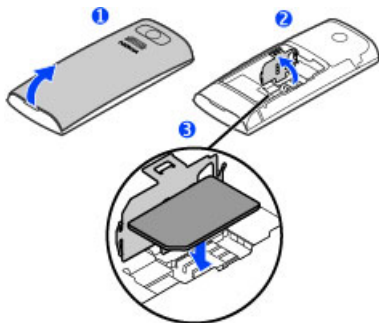

- 1 Place your finger in the recess at the bottom of the phone, and carefully lift and remove the back cover (1).
- 2 If the battery is inserted, lift it out.
- 3 Open the SIM card holder (2), and insert the SIM card (3). Make sure the contact area of the card is facing down.

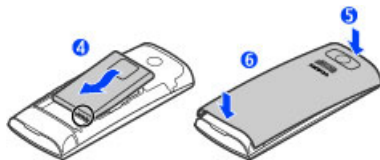

4

Line up the contacts of the battery and the battery compartment, and insert the battery (4). To replace the back cover, direct the top locking catches toward their slots (5), and press down until the cover locks into place (6).

Insert a second SIM card

Have a second SIM card, but want to keep using your main SIM card? You can insert or remove a second SIM card without switching the phone off.

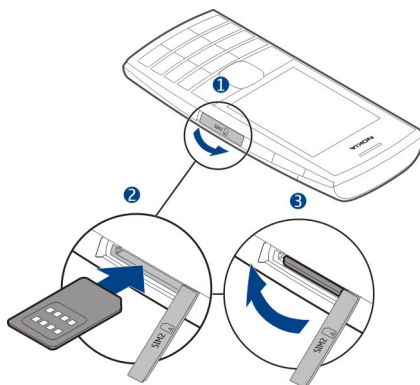

- 1 Open the cover of the external SIM card slot (1), marked with **SIM 2**.
- 2 Insert the SIM card (2). Make sure the contact area of the card is facing up. Push the card in, until it locks into place. Close the cover (3).

Insert a memory card

Use only compatible memory cards approved by Nokia for use with this device. Incompatible cards may damage the card and the device and corrupt data stored on the card.

Your phone supports memory cards with a capacity of up to 32 GB.

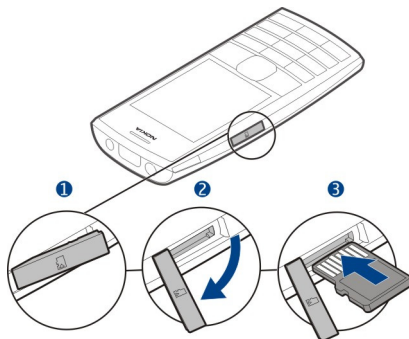

- 1 Open the memory card slot cover (1, 2).
- 2 Make sure the contact area of the card is facing up. Push the card in, until it locks into place (3).
- 3 Close the cover.

Remove the memory card

 **Important:** Do not remove the memory card when an application is using it. Doing so may damage the memory card and the device and corrupt data stored on the card.

You can remove or replace the memory card without switching the phone off.

- 1 Open the memory card slot cover.
- 2 Push the card in, until it is released, and pull the card out.
- 3 Close the cover.

Charge the battery

Your battery has been partially charged at the factory, but you may need to recharge it before you can switch on your phone for the first time. If the phone indicates a low charge, do the following:

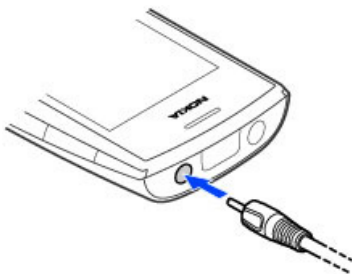

- 1 Connect the charger to a wall outlet.
- 2 Connect the charger to the phone.
- 3 When the phone indicates a full charge, disconnect the charger from the phone, then from the wall outlet.

You do not need to charge the battery for a specific length of time, and you can use the phone while it is charging.

If the battery is completely discharged, it may take several minutes before the charging indicator is displayed or before any calls can be made.

If the battery has not been used for a long time, to begin charging, you may need to connect the charger, then disconnect and reconnect it.

Switch the phone on or off

Press and hold the power key .



You may be prompted to get the configuration settings from your network service provider. For more information on this network service, contact your network service provider.

GSM antenna



The figure shows the GSM antenna area marked in grey.

Avoid touching the antenna area while the antenna is in use. Contact with antennas affects the communication quality and may reduce battery life due to higher power level during operation.

Connect a headset

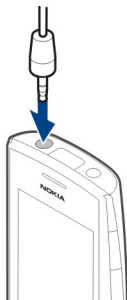

Do not connect products that create an output signal, as this may damage the device. Do not connect any voltage source to the Nokia AV connector. If you connect an external device or headset, other than those approved by Nokia for use with this device, to the Nokia AV connector, pay special attention to volume levels.

Attach a strap

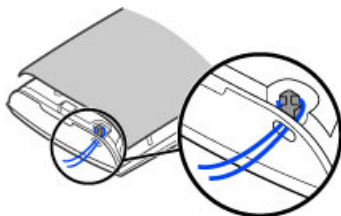

Straps may be available separately.

Basic use

Support

When you want to learn more about how to use your phone, or if you're unsure how your phone should work, read the user guide thoroughly.

If you have an issue, do the following:

- Reboot your phone. Switch off the phone, and remove the battery. After about a minute, replace the battery, and switch on the phone.
- Update your phone software
- Restore the original factory settings

If your issue remains unsolved, contact Nokia for repair options. Go to www.nokia.com/repair. Before sending your phone for repair, always back up your data, as all personal data in your phone may be deleted.

Access codes

The security code helps to protect your phone against unauthorised use. You can create and change the code, and set the phone to request the code. Keep the code secret and in a safe place separate from your phone. If you forget the code and your phone is locked, your phone will require service. Additional charges may apply, and all the personal data in your phone may be deleted. For more information, contact a Nokia Care point or your phone dealer.

The PIN code supplied with the SIM card protects the card against unauthorised use. The PIN2 code supplied with some SIM cards is required to access certain services. If you enter the PIN or PIN2 code incorrectly three times in succession, you are asked for the PUK or PUK2 code. If you do not have them, contact your service provider.

The module PIN is required to access the information in the security module of your SIM card. The signing PIN may be required for the digital signature. The barring password is required when using the call barring service.

To set how your phone uses the access codes and security settings, select **Menu > Settings > Security**.

Set which SIM card to use

You can set which SIM card to use for outgoing calls or messages. If you name your SIM cards, you can see at a glance which is, for example, for work and which is for personal use.

Select **Menu > SIM manager**.

Select **SIM1** or **SIM2**. The preferred SIM card is used by default for all outgoing communication, for example, calls and messages.

To be prompted to select a SIM card before, for example, making a call or sending a text message, select **Ask every time**.

Rename a SIM card

Select **Options** > **Rename**.

Tip: To quickly change the SIM card to use, on the home screen, press and hold *.

Lock the keys

To avoid accidentally making a call when your phone is in your pocket or bag, lock the keys.

Select **Menu**, and then press *.

Unlock the keys

Select **Unlock**, and press *.

Set the keys to lock automatically

- 1 Select **Menu** > **Settings and Device** > **Automatic keyguard** > **On**.
- 2 Define the length of time after which the keys are locked automatically.

Copy contacts or pictures from your old phone

Want to copy your content from your previous compatible Nokia phone and start using your new phone quickly? You can copy, for example, contacts, calendar entries, and pictures to your new phone, free of charge.

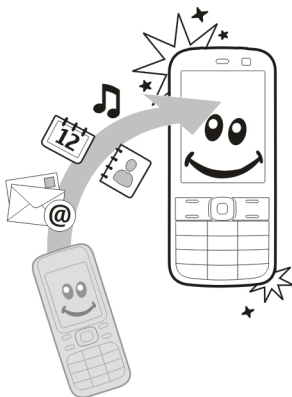

- 1 Activate Bluetooth in both phones.
Select **Menu** > **Settings** > **Connectivity** > **Bluetooth**.

- 2 Select **Menu** > **Settings** > **Sync & backup**.
- 3 Select **Phone switch** > **Copy to this**.
- 4 Select the content to copy and **Done**.
- 5 Select your previous phone from the list.
- 6 If the other phone requires a passcode, enter the passcode. The passcode, which you can define yourself, must be entered in both phones. The passcode in some phones is fixed. For details, see the user guide of the other phone.
The passcode is valid only for the current connection.
- 7 If prompted, allow connection and copying requests.

Use your phone without a SIM card

Do your children want to play with your phone, but you don't want them to accidentally make a call? Some features of your phone, such as games and the calendar, may be used without inserting a SIM card. Features that are dimmed in the menus cannot be used.

Calls

Make a call

- 1 Enter the phone number.
To delete a number, select **Clear**.
For international calls, select * twice for the + character (which replaces the international access code), and enter the country code, area code (omit the leading zero if necessary), and phone number.
- 2 Press the call key.
- 3 If prompted, select the SIM card to use.
- 4 To end the call, press the end key.

When you receive a call, the SIM card in use is indicated.

View your missed calls

Want to see who made the call you missed?

On the home screen, select **View**. The caller's name is displayed, if stored in the contacts list.

Missed and received calls are logged only if supported by the network, and the phone is switched on and within the network service area.

Call back the contact or number

Go to the contact or number, and press the call key.

View the missed calls later

Select **Menu** > **Contacts** > **Log and Missed calls**.

Call the last dialled number

Trying to call someone, but they are not answering? It is easy to call them again.

- 1 On the home screen, press the call key.
- 2 Go to the number, and press the call key.
If prompted, select the SIM card to use.

Divert calls to your voice mailbox or another phone number

When you cannot answer, you can divert your calls.

Call divert is a network service.

- 1 Select **Menu** > **Settings** > **Call** > **Call divert**.
- 2 Select the SIM card to use.
- 3 Select when to divert the incoming calls:

All voice calls — Divert all incoming voice calls.

If busy — Divert voice calls when busy.

If not answered — Divert voice calls only when not answered.

If out of reach — Divert voice calls when the phone is switched off or out of network coverage for a certain period.

If not available — Divert voice calls when not answered, or the phone is busy, or switched off, or out of network coverage.

- 4 Select **Activate** > **To voice mailbox** or **To other number**.
- 5 If **If not answered** or **If not available** is selected, set the length of time after which a call is forwarded.

Contacts**Save a name and phone number**

Select **Menu** > **Contacts**.

Select **Add new**.

If prompted, select where to save the contact.

Add or edit the details of a contact

- 1 Select **Names** and a contact.

2 Select **Options** > **Add detail**.

Tip: To add a ringtone or picture for a contact, select the contact and **Options** > **Add detail** > **Multimedia**.

Use speed dial

You can quickly call your friends and family when you assign your most-used phone numbers to the number keys of your phone.

You can only use speed dials for the contacts stored on your phone or on the SIM card in the internal SIM card holder.

Select **Menu** > **Contacts** > **More** > **Speed dials**.

Assign a phone number to a number key

- 1 Go to a number key, and select **Assign**. 1 is reserved for the voice mailbox.
- 2 Enter a number or search for a contact.

Remove or change a phone number assigned to a number key

Go to a number key, and select **Options** > **Delete** or **Change**.

Make a call

On the home screen, press and hold a number key.

Deactivate speed dialling

Select **Menu** > **Settings and Call** > **Speed dialling**.

Send your contact information

Want to send your phone number or mail address to a person you just met? Add your own contact information to your contacts list, and send a business card to the person.

Select **Menu** > **Contacts and Names**.

- 1 Select the contacts list entry that contains your information.
- 2 Select **Options** > **More** > **Business card** and the sending type.

Save a received business card

Select **Show** > **Save**.

Write text

Switch between text input modes

When writing text, you can use traditional  or predictive  text input.

Abc, abc, and ABC indicate the character cases. 123 indicates that number mode is activated.

Switch between text input methods

Select **Options** > **Prediction**. Not all languages are supported by predictive text input.

Switch between character cases

Select **#**.

Switch between the letter and number modes

Select and hold **#**.

Set the writing language

Select **Options** > **Writing language**.

Write using traditional text input

- 1 Press a number key (2-9) repeatedly, until the desired character is displayed.
- 2 Insert the next character. If it is located on the same key, wait until the cursor is displayed, or move the cursor.

The available characters depend on the selected writing language.

Move the cursor

Scroll left or right.

Insert a common punctuation mark

Press **1** repeatedly.

Insert a special character

Press *****, and select the desired character.

Insert a space

Press **0**.

Messaging**Send a message**

Keep in touch with your family and friends with text and multimedia messages. You can attach your pictures, videos, and business cards to your message.

Select **Menu** > **Messaging**.

- 1 Select **Create message**.

- 2 Write your message.
- 3 To add an attachment , select **Options > Insert object**.
- 4 Select **Send to**.
- 5 To enter a phone number or mail address manually, select **Number or mail**. Enter a phone number, or select **Mail**, and enter a mail address. To select a recipient or a contact group, select **Contacts** or **Contact groups**.
- 6 Select **Send**.
If prompted, select the SIM card to use.

Tip: To insert a special character or smiley, select **Options > Insert symbol**.

Sending a message with an attachment may be more expensive than sending a normal text message. For more information, contact your service provider.

You can send text messages that are longer than the character limit for a single message. Longer messages are sent as two or more messages. Your service provider may charge accordingly.

Characters with accents, other marks, or some language options, take more space, limiting the number of characters that can be sent in a single message.

If the item you insert in a multimedia message is too large for the network, the device may automatically reduce the size.

Only compatible devices can receive and display multimedia messages. Messages may look different in different devices.

Save an attachment

You can save attachments from multimedia and mail messages to your phone.

Save an attachment from a multimedia message

- 1 Select **Menu > Messaging**.
- 2 Open the message.
- 3 Select **Options > Show contents**.
- 4 Select the desired file and **Options > Save**.

Save an attachment from a mail

- 1 Select **Menu > Mail**.
- 2 Open the mail.
- 3 Select the attachment.
- 4 Select **View**, and download the attachment.

Pictures and videos are saved in Gallery.

Listen to voice messages

When you can't answer, you can divert calls to your voice mailbox and listen to your messages later.

You may need a voice mailbox subscription. For more information on this network service, contact your service provider.



You can only use the voice mailbox with the SIM card in the internal SIM card holder.

- 1 Select **Menu > Messaging > More > Voice messages and Voice mailbox no..**
- 2 Enter your voice mailbox number, and select **OK**.
- 3 To call your voice mailbox, on the home screen, press and hold **1**.

Send an audio message

Don't have time to write a text message? Record and send an audio message instead!

Select **Menu > Messaging**.

- 1 Select **More > Other messages > Audio message**.
- 2 To record your message, select .
- 3 To stop recording, select .
- 4 Select **Send to** and a contact.

Connectivity

Bluetooth

About Bluetooth connectivity

Select **Menu > Settings > Connectivity > Bluetooth**.

You can connect wirelessly to other compatible devices, such as phones, computers, headsets, and car kits.

You can use the connection to send items from your phone, copy files from your compatible PC, and print files with a compatible printer.

Since devices with Bluetooth wireless technology communicate using radio waves, they do not need to be in direct line-of-sight. However, they must be within 10 metres (33 feet) of each other, although the connection may be subject to interference from obstructions such as walls or from other electronic devices.

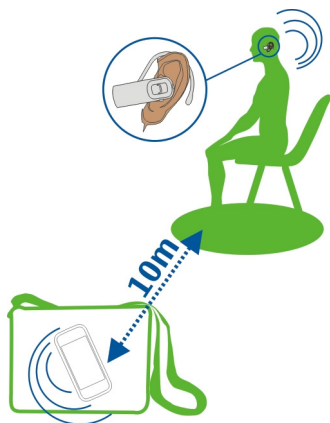

When your phone is locked, only connections to authorised devices are possible.

Tip: To access Bluetooth settings from the home screen, add a shortcut to the shortcut widget.



Note: There may be restrictions on the use of Bluetooth technology in some countries. For example, in France, you are only allowed to use Bluetooth technology indoors. After 1 July 2012, the restriction on outdoor usage of Bluetooth technology of this product in France is withdrawn by the EU. For more information, contact your local authorities.

Connect to a wireless headset

Want to keep working at your computer during a call? Use a wireless headset. You can also answer a call, even if your phone is not directly at hand.

- 1 Select **Menu > Settings > Connectivity > Bluetooth and Bluetooth > On.**
- 2 Switch the headset on.
- 3 To pair your phone and the headset, select **Conn. to audio acc..**
- 4 Select the headset. If the headset is not in the list, select **New search.**
- 5 You may need to enter a passcode. For details, see the user guide of the headset.

Send a picture or other content to another device using Bluetooth

Use Bluetooth to send pictures, videos, business cards, and other content created by you to your computer or a friend's compatible phone or device.

- 1 Select the item to send.
- 2 Select **Options > Send > Via Bluetooth**.
- 3 Select the device to connect to. If the desired device is not displayed, to search for it, select **New search**. Bluetooth devices within range are displayed.
- 4 If the other device requires a passcode, enter the passcode. The passcode, which you can define yourself, must be entered in both devices. The passcode in some devices is fixed. For details, see the user guide of the device.

The passcode is valid only for the current connection.

The available options may vary.

Connect automatically to a paired device

Do you regularly connect your phone to another Bluetooth device, such as a car kit, headset, or your PC? You can set your phone to connect automatically.

Select **Menu > Settings > Connectivity > Bluetooth and Paired devices**.

- 1 Select the phone to connect to automatically.
- 2 Select **Options > Settings > Auto-connect > Yes**.

Protect your phone

Do you want to secure who can see your phone when using Bluetooth? You can control who can find and connect to your phone.

Select **Menu > Settings > Connectivity > Bluetooth**.

Prevent others from detecting your phone

Select **Device visibility > Hidden**.

When your phone is hidden, others can't detect it. However, paired devices can still connect to your phone.

Deactivate Bluetooth

Select **Bluetooth > Off**.

Do not pair with or accept connection requests from an unknown device. This helps to protect your phone from harmful content.

USB data cable**Copy content between your phone and a computer**

You can use a USB data cable to copy your pictures and other content between your phone and a compatible computer.

- 1 Use a USB data cable to connect your phone to a computer.
- 2 Select from the following modes:

Nokia Suite — Nokia Suite is installed on your computer.

Media transfer — Nokia Suite is not installed on your computer. If you want to connect your phone to a home entertainment system or printer, use this mode.

Mass storage — Nokia Suite is not installed on your computer. The phone is displayed as a portable device on your computer. Make sure a memory card is inserted. If you want to connect your phone to other devices, such as a home or car stereo, use this mode.

- 3 To copy the content, use the file manager of the computer.
To copy your contacts, music files, videos, or pictures, use Nokia Suite.

Clock**Change the time and date**

Select **Menu > Settings and Date and time**.

Change the time zone when travelling

- 1 Select **Date & time settings > Time zone**.
- 2 To select the time zone of your location, scroll left or right.
- 3 Select **Save**.

The time and date are set according to the time zone. This makes sure that your phone displays the correct sending time of received text or multimedia messages.

For example, GMT -5 denotes the time zone for New York (USA), 5 hours west of Greenwich, London (UK).

Alarm clock

You can set an alarm to sound at a desired time.

Set the alarm

- 1 Select **Menu > Apps > Alarm clock**.
- 2 Enter the alarm time.

- 3 To repeat the alarm on selected days of the week, first go to **Repeat:**, and scroll left or right to select **On**. Then go to **Repeat days**, scroll right, mark the desired days of the week, and select **Done**.
- 4 To select the alarm tone, go to **Alarm tone**, and scroll left or right. If you select the radio as the alarm tone, connect a headset to the phone.
- 5 To set the length of the snooze time-out period, go to **Snooze time-out:**, and enter the desired time.
- 6 Select **Save**.

Stop the alarm

Select **Stop**. If you let the alarm sound for a minute or select **Snooze**, the alarm stops for the length of the snooze time-out period, then resumes.

Pictures and videos

Take a picture

- 1 Select **Menu > Photos > Camera**.
- 2 To zoom in or out, use the volume keys.
- 3 Select .

The pictures are saved in **Menu > Photos > My photos**.



Close the camera

Press the end key.

Record a video

Besides taking pictures with your phone, you can also capture your special moments as videos.

Select **Menu > Photos > Video camera**.

- 1 To switch from image mode to video mode, if necessary, select  > **Video c..**
- 2 To start recording, select .
To zoom in or out, use the volume keys.
- 3 To stop the recording, select .

Videos are saved in **Menu > Photos > My videos**.

Close the camera

Press the end key.

Send a picture or video

Want to share your pictures and videos with friends and family? Send a multimedia message or send a picture using Bluetooth.

Select **Menu** > **Photos**.

- 1 Select the folder containing the picture or video.
- 2 Go to the picture or video, and select **Options** > **Send** and the sending method.

Send several pictures or videos at the same time

- 1 Select the folder containing the pictures or videos.
- 2 Select **Options** > **Mark**, and mark the items.
- 3 Select **Options** > **Send marked** and the sending method.

Organise files

You can move, copy, and delete files and folders, or create new folders in your phone memory or on the memory card. If you organise your files into their own folders, it might help you find the files in future.

Select **Menu** > **Apps** > **Gallery**.

Create a new folder

In the folder where you want to create a sub-folder, select **Options** > **Add folder**.

Copy or move a file to a folder

Scroll to the file, and select **Options** > **Move**.

Tip: You can also play music or videos, or view pictures in Gallery.

Music and audio

Media player

Play a song

Play music stored in the phone memory or on the memory card.

Select **Menu** > **Music** > **My music** and **All songs**.

- 1 Select a song.
- 2 Select **Play**.
- 3 To pause or resume playing, press the scroll key.

Skip to the beginning of the current song

Scroll left.

Skip to the previous song

Scroll left twice.

Skip to the next song

Scroll right.

Fast-forward or rewind

Press and hold the scroll key to the right or left.

Mute or unmute the music player

Press #.

Close the music player

Press the end key.

Set the music player to play in the background

Select **Options** > **Play in background**.

Close the music player when it is playing in the background

Press and hold the end key.

Play a video

Play videos stored in the phone memory or on the memory card.

Select **Menu** > **Music** > **My music and Videos**.

- 1 Select a video.
- 2 Select **Play**.
- 3 To pause or resume playing, press the scroll key.

Fast-forward or rewind

Press and hold the scroll key to the right or left.

Close the media player

Press the end key.

FM radio**About the FM radio**

Select **Menu** > **Music** > **Radio**.

You can listen to FM radio stations using your phone - just select a station.

It is not possible to listen to the radio through a Bluetooth headset.



Listen to the radio

Your phone supports Nokia XpressRadio, allowing you to listen to radio stations with the built-in antenna. For better reception, connect a compatible headset to your phone. The headset acts as an external antenna.

Select **Menu > Music > Radio**.

Change the volume

Use the volume keys.

Listen using the headset or the loudspeaker

Select **Options > Settings > Play via** and the appropriate option.

Close the radio

Press the end key.

Set the radio to play in the background

Select **Options > Play in background**.

Close the radio when it is playing in the background

Press and hold the end key.

Find and save radio stations

Search for your favourite radio stations, and save them, so you can easily listen to them later.

Select **Menu > Music > Radio**.

Search for the next available station

Press and hold the scroll key left or right.

Save a station

Select **Options** > **Save station**.

Automatically search for radio stations

Select **Options** > **Search all stations**. For best results, search when outdoors or near a window.

Switch to a saved station

Scroll up or down.

Rename a station

- 1 Select **Options** > **Stations**.
- 2 Select the station and **Options** > **Rename**.

Automatically switch to a frequency with better reception

- 1 Select **Options** > **Settings** > **RDS** > **On**.
- 2 Select **Options** > **Settings** > **Auto-frequency** > **On**.

Tip: To access a station directly from the saved station list, press the number key that corresponds to the number of the station.

Play via radio**About the FM transmitter**

With the FM transmitter, you can play songs in your phone using a compatible FM receiver, such as a car radio or a home stereo system.



Note: Using FM transmitter may be restricted in some countries. For more information, contact your local authorities and go to www.nokia.com/fmtransmitter.

The operating distance of the FM transmitter is up to a maximum of 3 metres (10 feet). The transmission may be subject to interference due to obstructions, such as walls, other electronic devices, or from public radio stations. The FM transmitter may cause interference to nearby FM receivers operating on the same frequency. To avoid interference, always search for a free FM frequency on the receiver before using the FM transmitter.

The operating frequency of the transmitter ranges from 88.1 to 107.9 MHz.

The FM transmitter cannot be used while the headset or TV-out cable is connected.

Play music through a radio

Do you want to listen to music at a higher volume, or through better quality hi-fi stereo speakers? You can play music through an FM radio.

- 1 Tune the receiving radio to a free frequency.
- 2 Select **Menu > Music > My music**.
- 3 Select a song to be played.
- 4 Select **Options > Play via Radio**.
- 5 To set the frequency to which you tuned the receiving radio, use the keypad to enter the frequency, or scroll left or right. For example, if the frequency 107.8 MHz is free in your area and you tune your FM radio to that frequency, also tune the FM transmitter to 107.8 MHz.

To change the volume, use the volume function in the receiving radio. Make sure your phone volume is not muted.

Web**About the web browser**

Select **Menu > Apps > My apps > Nokia Browser**.

Catch up on the news, and visit your favourite websites. You can use the web browser to view web pages on the internet.

The web browser compresses and optimises web content for your phone, so you can browse the web more quickly and save on data costs.

To browse the web, you must be connected to the internet.

For availability, pricing, and instructions, contact your service provider.

You may receive the configuration settings required for browsing as a configuration message from your service provider.

Browse the web

Select **Menu > Apps > My apps > Nokia Browser**.

View your browsing history, featured sites, or your bookmarks

To switch between the History, Featured, and Favourites tabs, scroll left or right.

Go to a website

Select the address bar, and enter the address.

Search the internet

Select the search field, and enter a search word. If prompted, select your default search engine. You may need to select the SIM card you use to connect to the internet.

Return to a previously visited web page

Open the History tab, and select the web page.

Tip: You can download web apps from Nokia Store. When you first open a web app, it is added as a bookmark. For more information, go to www.nokia.com.





Fit a web page to your phone display

Your web browser can optimise web pages for your phone display. Instead of having to zoom in, the web page is arranged into a single column of larger, readable text and pictures.

Select **Menu > Apps > My apps > Nokia Browser**.

Select **Options > Tools > Column view**.

To quickly go to different sections of a web page, select from the following:

-  Go to the previous or next section of the web page.
-  Sign in to the web page.
-  Go to the main section of the web page.
-  Search the web page.
-  Read RSS feeds.

The available options may vary.

This view is not available for web sites designed for mobile use.

Add a bookmark

If you visit the same websites all the time, add them as bookmarks, so you can easily access them.

Select **Menu > Apps > My apps > Nokia Browser**.

While browsing, select **Options > Add to favourites**.

Go to a bookmarked website

Open the Favourites tab, and select a bookmark.

Clear your browsing history

Select **Menu > Apps > My apps > Nokia Browser**.

Open the History tab, and select **Options > Clear history**.

Clear stored cookies or text saved in web forms

Select **Options > Tools > Settings > Clear cookies or Clear auto-fill**.

Phone management

Update phone software using your phone

Want to improve the performance of your phone and get application updates and great new features? Update the software regularly to get the most out of your phone. You can also set your phone to automatically check for updates.

Using services or downloading content may cause transfer of large amounts of data, which may result in data traffic costs.

You can only update your software when using the SIM card in the internal SIM card holder.

Before starting the update, connect a charger or make sure the device battery has enough power.

Select **Menu > Settings**.



- 1 Select **Device > Device updates**.

- 2 To display the current software version and check whether an update is available, select **Current sw details**.
- 3 To download and install a software update, select **Downl. device sw**. Follow the displayed instructions.
- 4 If the installation was cancelled after the download, select **Install sw update**.

The software update may take several minutes. If there are problems with the installation, contact your network service provider.

Check for software updates automatically

Select **Auto sw update**, and define how often to check for new software updates.

Your network service provider may send phone software updates over the air directly to your phone. For more information on this network service, contact your network service provider.

Update phone software using your PC

You can use the Nokia Suite PC application to update your phone software. You need a compatible PC, a high-speed internet connection, and a compatible USB data cable to connect your phone to the PC.

To get more information and to download the Nokia Suite application, go to www.nokia.com/software.

Restore original settings

If your phone is not working properly, you can reset some settings to their original values.

- 1 End all calls and connections.
- 2 Select **Menu > Settings and Rest. fact. sett. > Settings only**.
- 3 Enter the security code.

This does not affect documents or files stored on your phone.

After restoring the original settings, your phone switches off and then on again. This may take longer than usual.

Back up your pictures and other content to a memory card

Want to make sure you will not lose any important files? You can back up your phone memory to a compatible memory card.

Select **Menu > Settings > Sync & backup**.

Select **Create backup**.

Restore a backup

Select **Restore backup**.

Protect the environment

Save energy

You do not need to charge your battery so often if you do the following:

- Close applications and data connections, such as your Bluetooth connection, when not in use.
- Deactivate unnecessary sounds, such as key tones.

Recycle



When this phone has reached the end of its working life, all of its materials can be recovered as materials and energy. To guarantee the correct disposal and reuse, Nokia co-operates with its partners through a program called We:recycle. For information on how to recycle your old Nokia products and where to find collection sites, go to www.nokia.com/werecycle, or call the Nokia Care contact centre.

Recycle packaging and user guides at your local recycling scheme.



The crossed-out wheeled-bin symbol on your product, battery, literature, or packaging reminds you that all electrical and electronic products, batteries, and accumulators must be taken to separate collection at the end of their working life. This requirement applies in the European Union. Do not dispose of these products as unsorted municipal waste. For more information on the environmental attributes of your phone, go to www.nokia.com/ecoprofile.

Product and safety information

General information

Network services and costs

Your device is approved for use on the EGSM 900 and 1800 MHz networks. To use the device, you need a subscription with a service provider.

Using network services and downloading content to your device requires a network connection and may result in data traffic costs. Some product features require support from the network, and you may need to subscribe to them.

Take care of your device

Handle your device, battery, charger and accessories with care. The following suggestions help you protect your warranty coverage.

- Keep the device dry. Precipitation, humidity, and all types of liquids or moisture can contain minerals that corrode electronic circuits. If your device gets wet, remove the battery, and allow the device to dry.
- Do not use or store the device in dusty or dirty areas. Moving parts and electronic components can be damaged.
- Do not store the device in high temperatures. High temperatures can shorten the life of the device, damage the battery, and warp or melt plastics.
- Do not store the device in cold temperatures. When the device warms to its normal temperature, moisture can form inside the device and damage electronic circuits.
- Do not attempt to open the device other than as instructed in the user guide.
- Unauthorised modifications may damage the device and violate regulations governing radio devices.
- Do not drop, knock, or shake the device. Rough handling can break internal circuit boards and mechanics.
- Only use a soft, clean, dry cloth to clean the surface of the device.
- Do not paint the device. Paint can clog the moving parts and prevent proper operation.
- Switch off the device and remove the battery from time to time for optimum performance.
- Keep your device away from magnets or magnetic fields.
- To keep your important data safe, store it in at least two separate places, such as your device, memory card, or computer, or write down important information.

Recycle

Always return your used electronic products, batteries, and packaging materials to dedicated collection points. This way you help prevent uncontrolled waste disposal and promote the recycling of materials. Check product environmental information and how to recycle your Nokia products at www.nokia.com/werecycle, or with a mobile device, nokia.mobi/werecycle.

About Digital Rights Management

When using this device, obey all laws and respect local customs, privacy and legitimate rights of others, including copyrights. Copyright protection may prevent you from copying, modifying, or transferring pictures, music, and other content.

Content owners may use different types of digital rights management (DRM) technologies to protect their intellectual property, including copyrights. This device uses various types of DRM software to access DRM-protected content. With this device you can access content protected with OMA DRM 1.0. If certain DRM software fails to protect the content, content owners may ask that such DRM software's ability to access new DRM-protected content be revoked. Revocation may also prevent renewal of such DRM-protected content already in your device. Revocation of such DRM software does not affect the use of content protected with other types of DRM or the use of non-DRM-protected content.

Digital rights management (DRM) protected content comes with an associated licence that defines your rights to use the content.

If your device has WMDRM-protected content, both the licences and the content are lost if the device memory is formatted. You may also lose the licences and the content if the files on your device become corrupted. Losing the licences or the content may limit your ability to use the same content on your device again. For more information, contact your service provider.

Batteries and chargers

Battery and charger information

Your device is intended for use with a BL-5C rechargeable battery. Nokia may make additional battery models available for this device. Always use original Nokia batteries.

This device is intended for use when supplied with power from the following chargers: AC-3. The exact Nokia charger model number may vary depending on the plug type, identified by E, X, AR, U, A, C, K, or B.

The battery can be charged and discharged hundreds of times, but it will eventually wear out. When the talk and standby times are noticeably shorter than normal, replace the battery.

Battery safety

Always switch the device off and disconnect the charger before removing the battery. When you unplug a charger or an accessory, hold and pull the plug, not the cord.

When your charger is not in use, unplug it from the electrical plug and the device. Do not leave a fully charged battery connected to a charger, as overcharging may shorten the battery's lifetime. If left unused, a fully charged battery will lose its charge over time.

Always keep the battery between 15°C and 25°C (59°F and 77°F). Extreme temperatures reduce the capacity and lifetime of the battery. A device with a hot or cold battery may not work temporarily.

Accidental short-circuiting can happen when a metallic object touches the metal strips on the battery, for example, if you carry a spare battery in your pocket. Short-circuiting may damage the battery or the connecting object.

Do not dispose of batteries in a fire as they may explode. Dispose of batteries according to local regulations. Recycle when possible. Do not dispose as household waste.

Do not dismantle, cut, open, crush, bend, puncture, or shred cells or batteries. If a battery leaks, do not let battery liquid touch skin or eyes. If this happens, immediately flush the affected areas with water, or seek medical help.

Do not modify, remanufacture, attempt to insert foreign objects into the battery, or immerse or expose it to water or other liquids. Batteries may explode if damaged.

Use the battery and charger for their intended purposes only. Improper use, or use of unapproved batteries or incompatible chargers may present a risk of fire, explosion, or other hazard, and may invalidate any approval or warranty. If you believe the battery or charger is damaged, take it to a service centre for inspection before continuing to use it. Never use a damaged battery or charger. Only use the charger indoors.

Additional safety information

Make an emergency call

- 1 Make sure the device is switched on.
- 2 Check for adequate signal strength. You may also need to do the following:
 - Insert a SIM card.
 - Deactivate call restrictions you have activated for your device, such as call barring, fixed dialling, or closed user group.
 - Make sure the flight profile is not activated.
- 3 Press the end key repeatedly, until the home screen is displayed.
- 4 Enter the official emergency number for your present location. Emergency call numbers vary by location.
- 5 Press the call key.
- 6 Give the necessary information as accurately as possible. Do not end the call until given permission to do so.



Important: Activate both cellular and internet calls, if your device supports internet calls. The device may attempt to make emergency calls both through cellular networks and through your internet call service provider. Connections in all conditions cannot be guaranteed. Never rely solely on any wireless device for essential communications like medical emergencies.

Small children

Your device and its accessories are not toys. They may contain small parts. Keep them out of the reach of small children.

Medical devices

Operation of radio transmitting equipment, including wireless phones, may interfere with the function of inadequately protected medical devices. Consult a physician or the manufacturer of the medical device to determine whether they are adequately shielded from external RF energy. Switch off your device when regulations posted instruct you to do so, for example, in hospitals.

Implanted medical devices

Manufacturers of medical devices recommend a minimum separation of 15.3 centimetres (6 inches) between a wireless device and an implanted medical device, such as a pacemaker or implanted cardioverter defibrillator, to avoid potential interference with the medical device. Persons who have such devices should:

- Always keep the wireless device more than 15.3 centimetres (6 inches) from the medical device.
- Not carry the wireless device in a breast pocket.
- Hold the wireless device to the ear opposite the medical device.
- Turn the wireless device off if there is any reason to suspect that interference is taking place.
- Follow the manufacturer directions for the implanted medical device.

If you have any questions about using your wireless device with an implanted medical device, consult your health care provider.

Hearing



Warning:

When you use the headset, your ability to hear outside sounds may be affected. Do not use the headset where it can endanger your safety.

Some wireless devices may interfere with some hearing aids.

Nickel

The surface of this device is nickel-free.

Protect your device from harmful content

Your device may be exposed to viruses and other harmful content. Take the following precautions:

- Be cautious when opening messages. They may contain malicious software or otherwise be harmful to your device or computer.
- Be cautious when accepting connectivity requests, browsing the internet, or downloading content. Do not accept Bluetooth connections from sources you do not trust.
- Only install and use services and software from sources that you trust and that offer adequate security and protection.
- Install antivirus and other security software on your device and any connected computer. Only use one antivirus application at a time. Using more may affect performance and operation of the device and/or computer.

36 Product and safety information

- If you access preinstalled bookmarks and links to third party internet sites, take the appropriate precautions. Nokia does not endorse or assume liability for such sites.

Operating environment

This device meets RF exposure guidelines in the normal use position at the ear or at least 1.5 centimetres (5/8 inch) away from the body. Any carry case, belt clip, or holder for body-worn operation should not contain metal and should position the device the above-stated distance from your body.

To send data files or messages requires a quality connection to the network. Data files or messages may be delayed until such a connection is available. Follow the separation distance instructions until the transmission is completed.

Parts of the device are magnetic. Metallic materials may be attracted to the device. Do not place credit cards or other magnetic storage media near the device, because information stored on them may be erased.

Vehicles

Radio signals may affect improperly installed or inadequately shielded electronic systems in motor vehicles such as electronic fuel injection, electronic antilock braking, electronic speed control, and air bag systems. For more information, check with the manufacturer of your vehicle or its equipment.

Only qualified personnel should install the device in a vehicle. Faulty installation or service may be dangerous and may invalidate your warranty. Check regularly that all wireless device equipment in your vehicle is mounted and operating properly. Do not store or carry flammable liquids, gases, or explosive materials in the same compartment as the device, its parts, or accessories. Remember that air bags inflate with great force. Do not place your device or accessories in the air bag deployment area.

Switch off your device before boarding an aircraft. The use of wireless devices in an aircraft may be dangerous to the operation of the aircraft and may be illegal.

Potentially explosive environments

Switch off your device in any area with a potentially explosive atmosphere. Obey all posted instructions. Sparks in such areas could cause an explosion or fire resulting in bodily injury or death. Switch off the device at refuelling points such as near gas pumps at service stations. Observe restrictions in fuel depots, storage, and distribution areas; chemical plants; or where blasting operations are in progress. Areas with a potentially explosive atmosphere are often, but not always, clearly marked. They include areas where you would be advised to turn off your vehicle engine, below deck on boats, chemical transfer or storage facilities and where the air contains chemicals or particles such as grain, dust, or metal powders. You should check with the manufacturers of vehicles using liquefied petroleum gas (such as propane or butane) to determine if this device can be safely used in their vicinity.

Certification information (SAR)

This mobile device meets guidelines for exposure to radio waves.

Your mobile device is a radio transmitter and receiver. It is designed not to exceed the limits for exposure to radio waves recommended by international guidelines. These guidelines were developed by the independent scientific organisation ICNIRP and include safety margins designed to assure the protection of all persons, regardless of age and health.

The exposure guidelines for mobile devices employ a unit of measurement known as the Specific Absorption Rate or SAR. The SAR limit stated in the ICNIRP guidelines is 2.0 watts/kilogram (W/kg) averaged over 10 grams of tissue. Tests for SAR are conducted using standard operating positions with the device transmitting at its highest certified power level in all tested frequency bands. The actual SAR level of an operating device can be below the maximum value because the device is designed to use only the power required to reach the network. That amount changes depending on a number of factors such as how close you are to a network base station.

The highest SAR value under the ICNIRP guidelines for use of the device at the ear is 0.91 W/kg.

Use of device accessories may result in different SAR values. SAR values may vary depending on national reporting and testing requirements and the network band. Additional SAR information may be provided under product information at www.nokia.com.

Copyright and other notices

DECLARATION OF CONFORMITY

CE 0434
CE 0168

Nokia is transitioning between EU Notified Bodies and this product has been approved as complying with EU regulations with both Notified Bodies. Either of the CE marks shown may appear on the product during this transition period.

Hereby, NOKIA CORPORATION declares that this RM-694 product is in compliance with the essential requirements and other relevant provisions of Directive 1999/5/EC. A copy of the Declaration of Conformity can be found at <http://www.nokia.com/global/declaration>.

© 2011 Nokia. All rights reserved.

Nokia, Nokia Connecting People, and Navi are trademarks or registered trademarks of Nokia Corporation. Nokia tune is a sound mark of Nokia Corporation. Other product and company names mentioned herein may be trademarks or tradenames of their respective owners.

Reproduction, transfer, distribution, or storage of part or all of the contents in this document in any form without the prior written permission of Nokia is prohibited. Nokia operates a policy of continuous development. Nokia reserves the right to make changes and improvements to any of the products described in this document without prior notice.



Includes RSA BSAFE cryptographic or security protocol software from RSA Security.



Java is a trademark of Sun Microsystems, Inc.

This product is licensed under the MPEG-4 Visual Patent Portfolio License (i) for personal and noncommercial use in connection with information which has been encoded in compliance with the MPEG-4 Visual Standard by a consumer engaged in a personal and noncommercial activity and (ii) for use in connection with MPEG-4 video provided by a licensed video provider. No license is granted or shall be implied for any other use. Additional information, including that related to promotional, internal, and commercial uses, may be obtained from MPEG LA, LLC. See <http://www.mpegla.com>.

To the maximum extent permitted by applicable law, under no circumstances shall Nokia or any of its licensors be responsible for any loss of data or income or any special, incidental, consequential or indirect damages howsoever caused.

The contents of this document are provided "as is". Except as required by applicable law, no warranties of any kind, either express or implied, including, but not limited to, the implied warranties of merchantability and fitness for a particular purpose, are made in relation to the accuracy, reliability or contents of this document. Nokia reserves the right to revise this document or withdraw it at any time without prior notice.

The availability of products, features, applications and services may vary by region. For more information, contact your Nokia dealer or your service provider. This device may contain commodities, technology or software subject to export laws and regulations from the US and other countries. Diversion contrary to law is prohibited.

Nokia does not provide a warranty for or take any responsibility for the functionality, content, or end-user support of third-party applications provided with your device. By using an application, you acknowledge that the application is provided as is. Nokia does not make any representations, provide a warranty, or take any responsibility for the functionality, content, or end-user support of third-party applications provided with your device.

/Issue 1.1 EN

Index**A**

| | |
|--------------|----|
| access codes | 12 |
| alarm clock | 22 |
| antennas | 10 |

B

| | |
|------------------------|------------|
| backing up data | 31 |
| battery | 7, 34 |
| — charging | 9 |
| Bluetooth | 19, 20, 21 |
| bookmarks | 29 |
| browser | |
| <i>See web browser</i> | |
| business cards | 16, 21 |

C

| | |
|-------------------------------|--------|
| cable connection | 22 |
| calls | |
| — diverting | 15 |
| — emergency | 34 |
| — log | 14, 15 |
| — making | 14, 15 |
| camera | |
| — recording videos | 23 |
| — sending pictures and videos | 24 |
| — taking pictures | 23 |
| charging the battery | 34 |
| clock | 22 |
| contacts | |
| — adding | 15 |
| — copying | 13 |
| — saving | 15 |
| — sending | 16 |
| copying content | 13, 22 |

D

| | |
|------------------|--------|
| data connections | |
| — Bluetooth | 19, 20 |

| | |
|-----------------|----|
| date and time | 22 |
| diverting calls | 15 |

E

| | |
|--------------------|----|
| emergency calls | 34 |
| environmental tips | 32 |

F

| | |
|-----------------------------|--------|
| factory settings, restoring | 31 |
| file management | 24 |
| FM radio | 25, 26 |
| FM transmitter | 27, 28 |

H

| | |
|---------|----|
| headset | 11 |
|---------|----|

I

| | |
|------------------------|--|
| internet | |
| <i>See web browser</i> | |

K

| | |
|----------------|----|
| keyguard | 13 |
| keys and parts | 5 |

L

| | |
|---------|----|
| locking | |
| — keys | 13 |

M

| | |
|----------------------------------|--------|
| mailbox | |
| — voice | 19 |
| memory card | 8 |
| messages | |
| — attachments | 18 |
| — audio | 19 |
| — sending | 17 |
| MMS (multimedia message service) | 17 |
| multimedia messages | 17 |
| music | 24, 28 |

N

| | |
|---------------------------|----|
| Nokia support information | 11 |
|---------------------------|----|

O

| | |
|-----------------|----|
| offline profile | 14 |
|-----------------|----|

P

| | |
|-----------|----|
| passwords | 12 |
|-----------|----|

| | |
|-------|--|
| phone | |
|-------|--|

| | |
|--------------------|----|
| — switching on/off | 10 |
|--------------------|----|

| | |
|--------------|----|
| Phone switch | 13 |
|--------------|----|

| | |
|----------|--|
| pictures | |
|----------|--|

| | |
|-----------|--------|
| — copying | 13, 22 |
|-----------|--------|

| | |
|-----------|--------|
| — sending | 21, 24 |
|-----------|--------|

| | |
|----------|----|
| — taking | 23 |
|----------|----|

| | |
|----------|----|
| PIN code | 12 |
|----------|----|

| | |
|-----------------|----|
| powering on/off | 10 |
|-----------------|----|

| | |
|-----------------------|----|
| predictive text input | 16 |
|-----------------------|----|

R

| | |
|-------|--------|
| radio | 25, 26 |
|-------|--------|

| | |
|-----------|--|
| recording | |
|-----------|--|

| | |
|----------|----|
| — videos | 23 |
|----------|----|

| | |
|-----------|----|
| recycling | 32 |
|-----------|----|

| | |
|----------------|----|
| restoring data | 31 |
|----------------|----|

| | |
|--------------------|----|
| restoring settings | 31 |
|--------------------|----|

S

| | |
|-----------|--|
| searching | |
|-----------|--|

| | |
|------------------|----|
| — radio stations | 26 |
|------------------|----|

| | |
|---------------|----|
| security code | 12 |
|---------------|----|

| | |
|----------|--|
| settings | |
|----------|--|

| | |
|-------------|----|
| — restoring | 31 |
|-------------|----|

| | |
|----------|--------------|
| SIM card | 5, 7, 12, 14 |
|----------|--------------|

| | |
|-----------------------------|----|
| SMS (short message service) | 17 |
|-----------------------------|----|

| | |
|------------------|--------|
| software updates | 30, 31 |
|------------------|--------|

| | |
|----------------|----|
| speed dialling | 16 |
|----------------|----|

| | |
|-------|----|
| strap | 11 |
|-------|----|

| | |
|---------|----|
| support | 11 |
|---------|----|

| | |
|------------------|----|
| switching on/off | 10 |
|------------------|----|

T

| | |
|-----------------|--|
| taking pictures | |
|-----------------|--|

| | |
|-------------------|--|
| See <i>camera</i> | |
|-------------------|--|

| | |
|------------|--------|
| text input | 16, 17 |
|------------|--------|

| | |
|---------------|----|
| text messages | 17 |
|---------------|----|

| | |
|---------------|----|
| time and date | 22 |
|---------------|----|

| | |
|----------------------|--------|
| transferring content | 13, 22 |
|----------------------|--------|

| | |
|----------------|----|
| turning on/off | 10 |
|----------------|----|

U

| | |
|---------|--|
| updates | |
|---------|--|

| | |
|------------------|--------|
| — phone software | 30, 31 |
|------------------|--------|

| | |
|----------------|----|
| USB connection | 22 |
|----------------|----|

V

| | |
|--------|--|
| videos | |
|--------|--|

| | |
|-----------|--------|
| — copying | 13, 22 |
|-----------|--------|

| | |
|-----------|----|
| — playing | 25 |
|-----------|----|

| | |
|-------------|----|
| — recording | 23 |
|-------------|----|

| | |
|-----------|--------|
| — sending | 21, 24 |
|-----------|--------|

| | |
|----------------|----|
| voice messages | 19 |
|----------------|----|

W

| | |
|-------------|----|
| web browser | 28 |
|-------------|----|

| | |
|-------------|----|
| — bookmarks | 29 |
|-------------|----|

| | |
|------------------|--------|
| — browsing pages | 28, 29 |
|------------------|--------|

| | |
|-----------|----|
| — cookies | 30 |
|-----------|----|